

# Android Phones (Samsung, Google Pixel etc)

Email setup



1) For this setup, we will be adding the email through the Gmail app. Open it up and tap the icon in the top right.

Note: If you've never downloaded Gmail then you will be prompted to make a new account. In any case, just add a new account (and skip to 2b. below).

2a) Select "Add Another Account".

2b) Then, choose "Other" from the list.

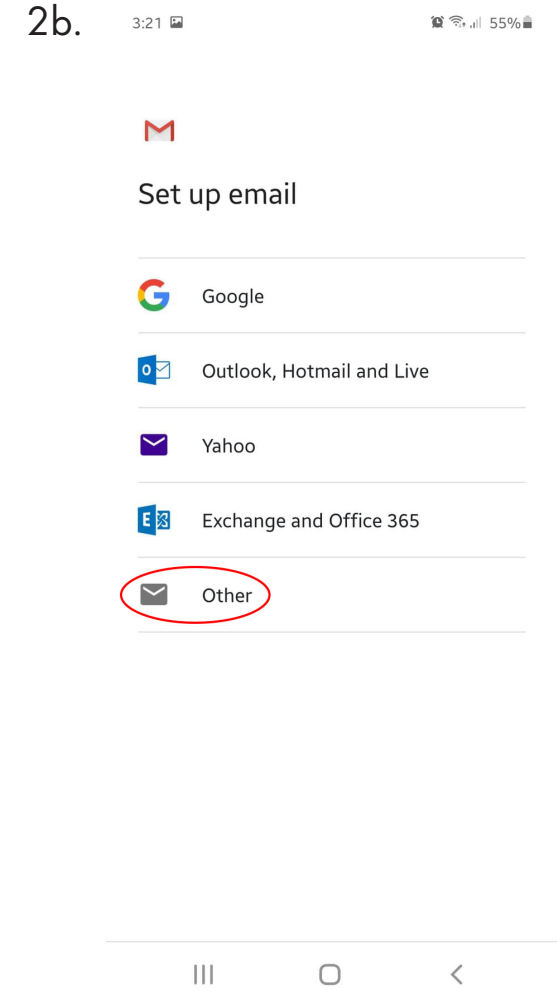
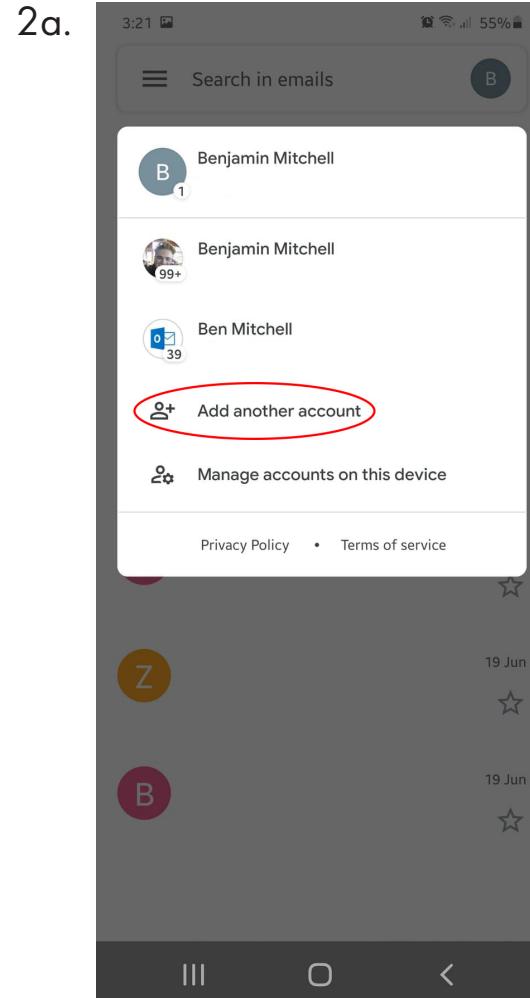
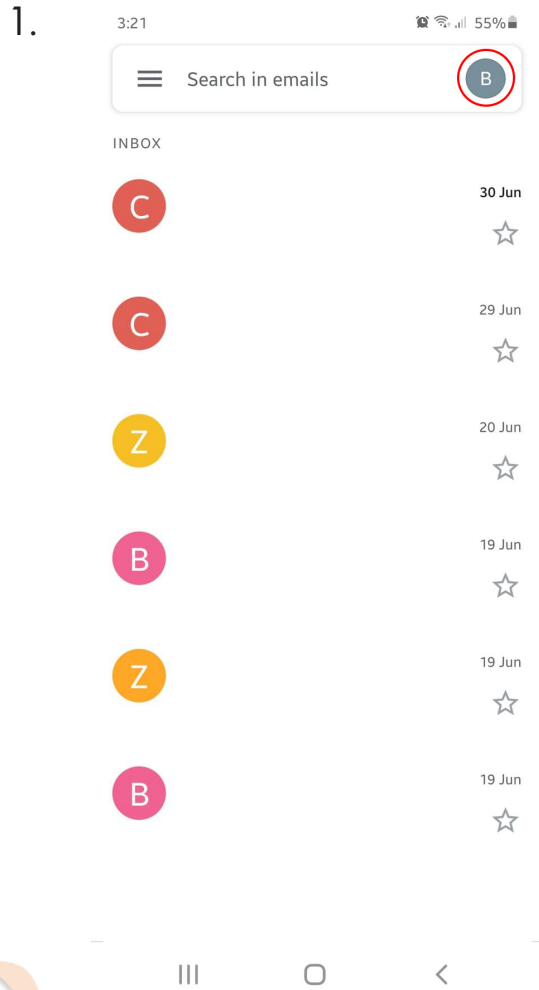

3) In the box on screen, fill in your new email address you're setting up. Then select "Manual Setup".

4) Select "Personal (IMAP)".

5) Type in your new password (this can be found in the Order Completion email we've sent to your correspondence email).

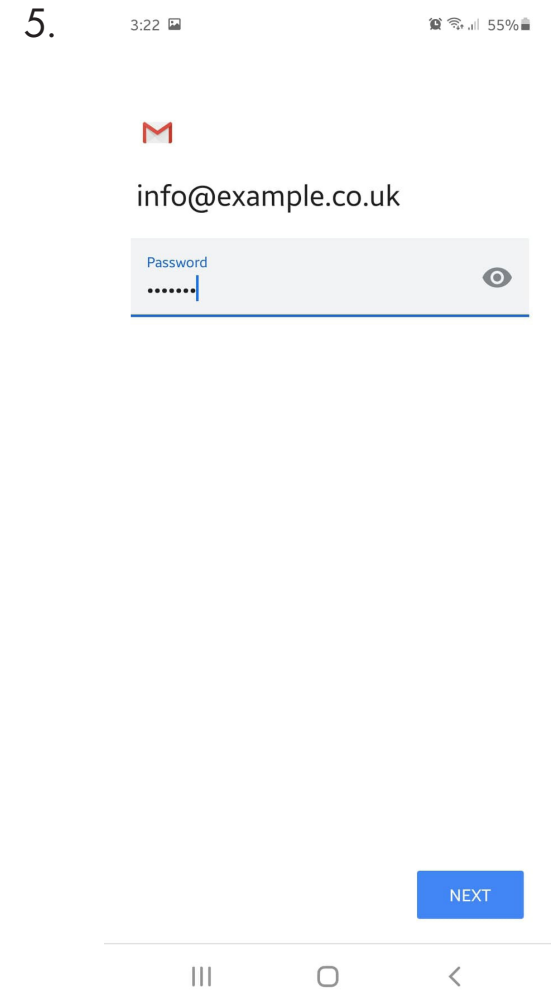
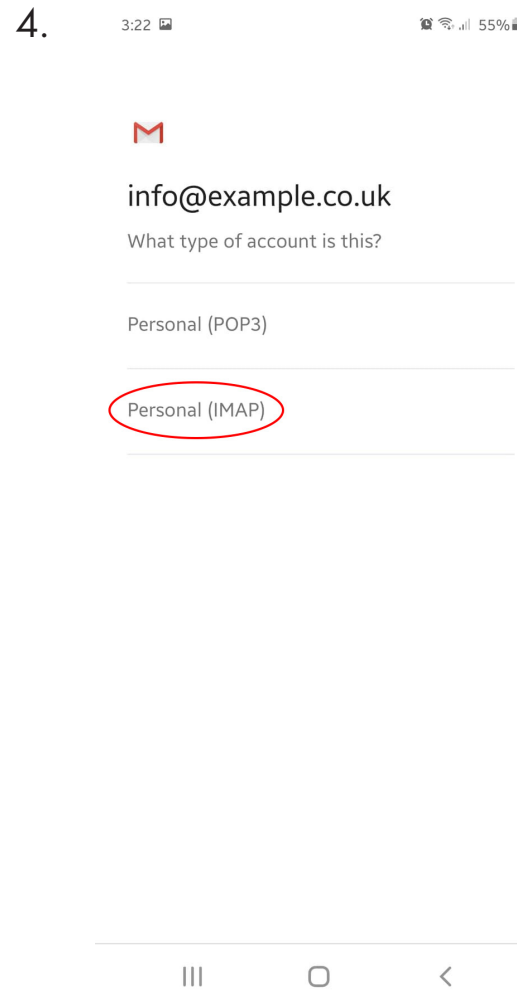
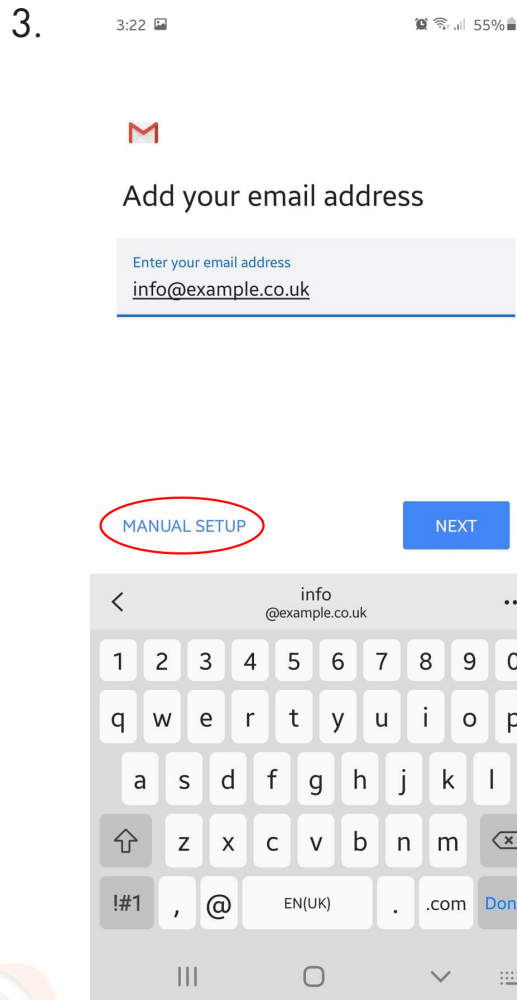

6) After successfully entering all your details so far, you will now need to enter the following Incoming Server Settings when prompted:

- Username: [enter your email address]
- Password: [enter your password]
- Server: server.promoteukltd.com

7) After tapping Next, please check the server settings are in place by:

1. Sending an email to the new email address.
2. Sending an email from the new email address.

If the above succeeds then you're all done!

If however you're experiencing issues then please continue to step 8).

6.

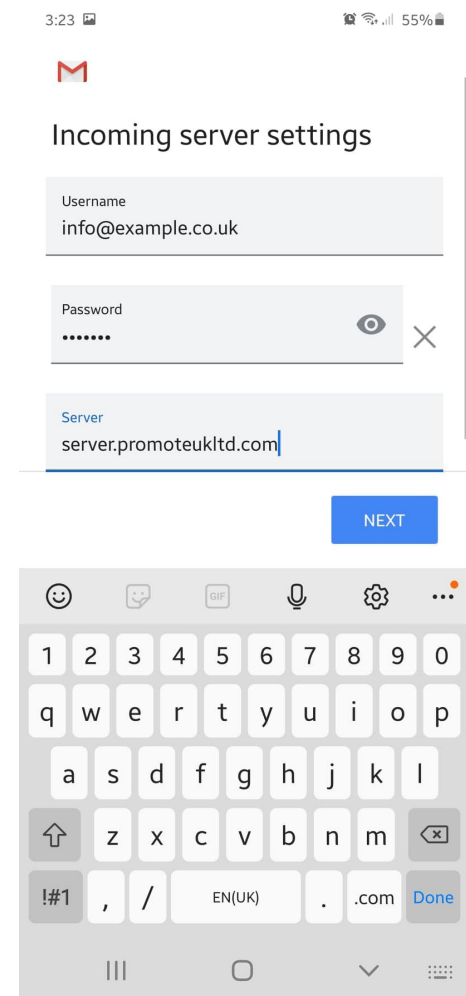

8) Return back to the screen shown below in "8." - from here, select "Manage accounts on this device".

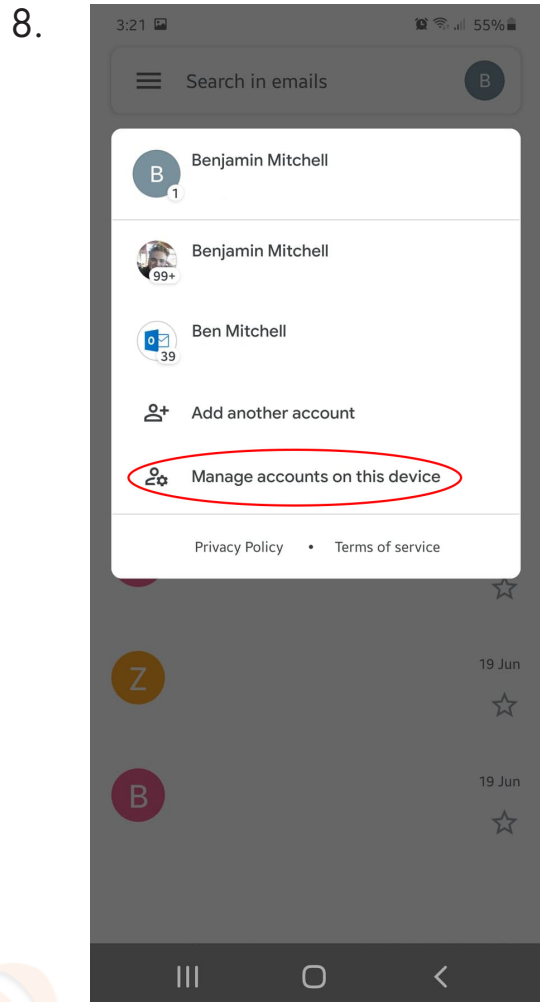

9) On the next screen, select the account you're trying to add. Then select "Account settings".

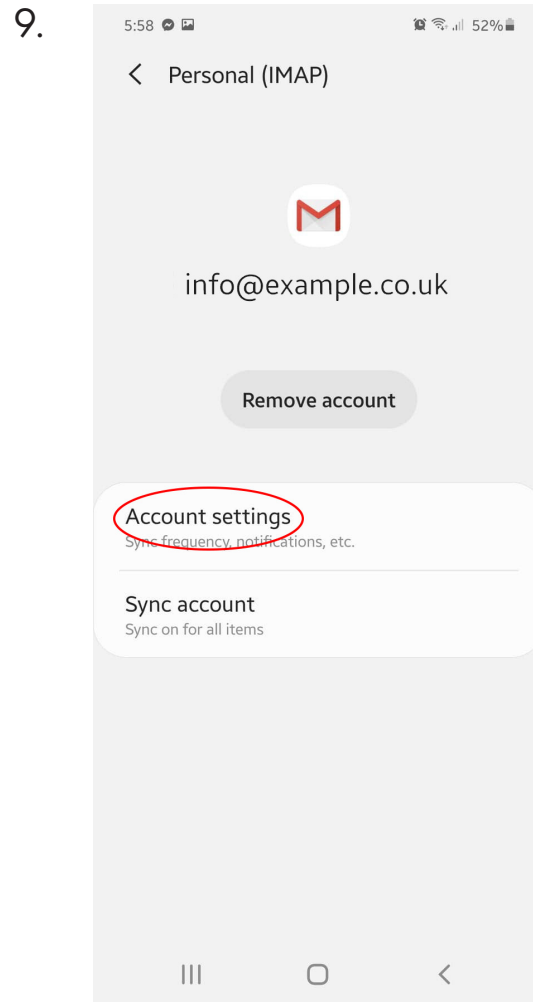

10) On the next screen, click the account name once more, then scroll down to the server settings.

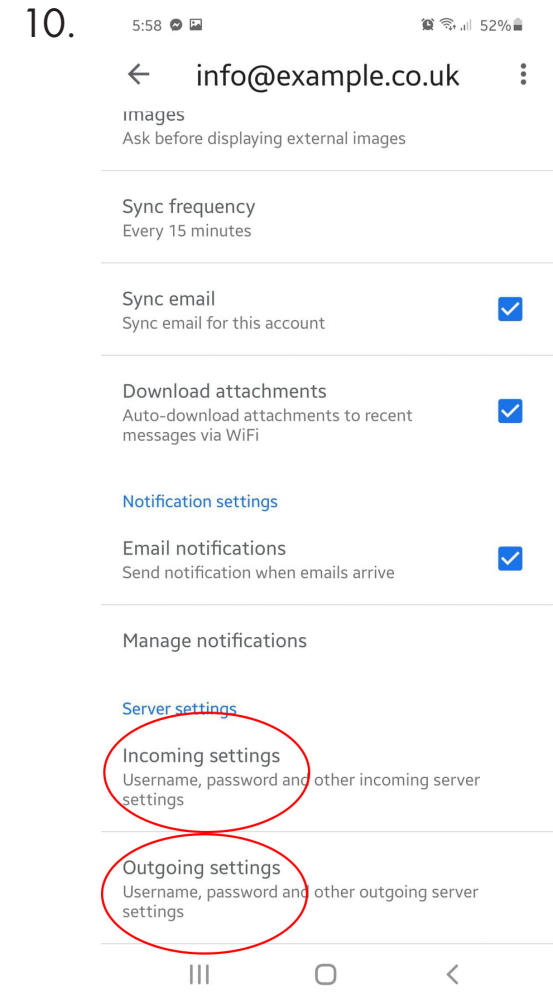

11) From here, you'll need go into the settings for both Incoming and Outgoing servers (image to the right is what that looks like).

Server settings for each are detailed below:

### Incoming Server

- Username: [enter your email address]
- Password: [enter your password]
- Sever: server.promoteukltd.com
- Port: **993**
- Security type: SSL/TLS

### Outgoing Server

- Username: [enter your email address]
- Password: [enter your password]
- Sever: server.promoteukltd.com
- Port: **465**
- Security type: SSL/TLS

By now, you should be up and running without any issues!

Tip: if at this stage you're still having trouble, please check your password that you haven't accidentally mistaken the *number "0"* for the *letter "O"*.

Otherwise please do not hesitate to get in touch on our main office line for further assistance.

11.

